



Product Name: ADVANTAGE FOR DOGS OVER 25 KG

APVMA Approval No: 50400/ 131035

Label Name:	ADVANTAGE FOR DOGS OVER 25 KG
Signal Headings:	CAUTION KEEP OUT OF REACH OF CHILDREN READ SAFETY DIRECTIONS FOR ANIMAL TREATMENT ONLY
Constituent Statements:	100 g/L IMIDACLOPRID
Claims:	<p>Fleas Once a month topical flea and lice treatment Stops fleas feeding in 3-5 minutes Convenient, easy to apply Water resistant formulation</p> <p>For the treatment and prevention of fleas (<i>Ctenocephalides</i> spp) on large dogs. Larval flea stages are killed in the surroundings of Advantage treated pets. Reduces the incidence of Flea Allergy Dermatitis. For the control of lice (<i>Trichodectes canis</i>, <i>Linognathus setosus</i>) on dogs. One application on the skin lasts for a month on dogs.</p> <p>If problems persist consult your veterinarian.</p>
Net Contents:	<p>1 x 4 mL 2 x 4 mL 4 x 4 mL 6 x 4 mL</p> <p>It is illegal to sell individual tubes separately.</p>
Directions for Use:	
Restraints:	DO NOT USE in rabbits that may be consumed or processed for human consumption.
Contraindications:	

Precautions:	
--------------	--

Side Effects:	
---------------	--

Dosage and Administration:	<p>For external application only</p> <p>One applicator treats dogs 25-50 kg bodyweight. Two applicators treats dogs over 50 kg bodyweight.</p> <p>For very large dogs over 50 kg, apply 2 tubes of Advantage for Dogs over 25 kg using one tube between the shoulder blades and one tube on the midline of the back between the hips.</p> <ol style="list-style-type: none"> 1. Remove required tube(s) from the package 2. Hold tube upright and pull off the cap. 3. Reverse the cap and push cap back on tube. 4. Twist cap to break seal, then remove cap from tube. 5. Site of Application <p>DOGS 25-50 kg 1 TUBE Apply by dividing the dose between the shoulder blades, on the midline of the back between the hips, and at one point in between.</p> <ol style="list-style-type: none"> 6. The animal should be standing for easy application. Remove any collar prior to application and replace when product is dry. Part the hair until the skin is visible. Place the tip of the tube on the skin and squeeze the tube firmly twice to apply the solution directly on the skin. Avoid pet's eyes or mouth. If licked by cats, signs of distaste may be observed due to the bitter taste. 7. Record treatment date and repeat monthly or as required. ADVANTAGE remains efficacious following shampoo treatment, swimming or exposure to rain. Avoid applying the product while the animal is wet. If washing animal during use of this product use a soap free shampoo. 8. Occasionally hair loss may occur at the application site. This is usually a single occurrence and hair will grow back uneventfully.
----------------------------	---

General Directions:	This section contains file attachment.
---------------------	--

Withholding Periods:	
----------------------	--

Trade Advice:	
---------------	--

Safety Directions:	Harmful if inhaled or swallowed. Will irritate the eyes. Avoid contact with eyes. Do not inhale vapour. If product in eyes, wash it out immediately with water. Wash hands after use.
--------------------	---

First Aid Instructions:	If poisoning occurs, contact a doctor or Poisons Information Centre. Phone Australia 131126.
-------------------------	--

First Aid Warnings:	
---------------------	--

Additional User Safety:	
-------------------------	--

Environmental Statements:	
---------------------------	--

Disposal:	Dispose of container by wrapping with paper and putting in garbage.
-----------	---

Storage:	Store below 30°C (room temperature)
----------	-------------------------------------

Advantage (Cat and Dog) – COMMON LEAFLET

CAUTION

KEEP OUT OF REACH OF CHILDREN

READ SAFETY DIRECTIONS

FOR ANIMAL TREATMENT ONLY

ADVANTAGE FOR DOGS & CATS

ACTIVE CONSTITUENT

100 g/L IMIDACLOPRID

For the treatment and prevention of fleas (*Ctenocephalides* spp.) on dogs, cats, rabbits and ferrets. Larval flea stages are killed in the surroundings of ADVANTAGE treated pets. Reduces the incidence of Flea Allergy Dermatitis. For the control of lice (*Trichodectes canis*, *Linognathus setosus*) on dogs. One application on the skin lasts for a month on dogs and up to a month on cats.

DIRECTIONS FOR USE

RESTRAINT

DO NOT USE on rabbits that may be consumed or processed for human consumption.

DOSAGE

FOR EXTERNAL APPLICATION ONLY



animals of this type ↓	Use 1 TUBE from this pack colour ↓
Small cats & kittens up to 4 kg	dark orange
Cats over 4 kg	violet
Small dogs & puppies, rabbits and ferrets up to 4 kg	dark green
Dogs, rabbits and ferrets 4-10 kg	turquoise
Dogs 10-25 kg	maroon
Dogs over 25-50 kg	blue

For very large dogs over 50 kg, apply 2 tubes of ADVANTAGE for Dogs Over 25 kg (blue) using one tube between the shoulder blades and one tube on the midline of the back between the hips.

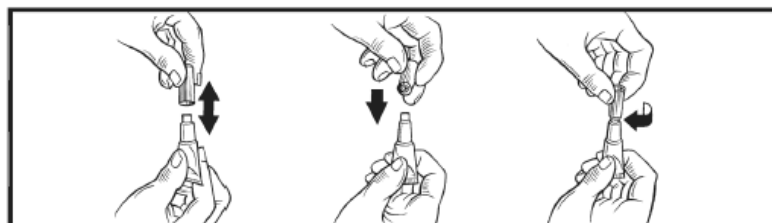
1. Remove required tube(s) from the package
2. Hold tube upright and pull off the cap.
3. Reverse the cap and push cap back on tube.
4. Twist cap to break seal, then remove cap from tube.



5. Site of Application

CATS	DOGS UNDER 25 kg	DOGS 25–50 kg
1 TUBE Apply on the back of the neck.	1 TUBE Apply between the shoulder blades.	1 TUBE Apply by dividing the dose between the shoulder blades, on the midline of the back between the hips, and at one point in between.
		

6. The animal should be standing for easy application. Remove any collar prior to application and replace when product is dry. Part the hair until the skin is visible. Place the tip of the tube on the skin and squeeze the tube firmly **twice to apply the solution directly on the skin**. Avoid pet's eyes or mouth. If licked by cats, signs of distaste may be observed due to the bitter taste.

7. Record treatment date and repeat monthly or as required. ADVANTAGE remains efficacious following shampoo treatment, swimming or exposure to rain. Avoid applying the product while the animal is wet. If washing animal during use of this product use a soap free shampoo.

8. Occasionally hair loss may occur at the application site. This is usually a single occurrence and hair will grow back uneventfully.

GENERAL INSTRUCTIONS

ADVANTAGE has been shown to kill adult and larval fleas within 20 minutes of contact by absorption via the flea intersegmental membranes. Stops fleas from feeding in 3-5 minutes. Fleas are not required to bite the animal to receive a lethal dose.

The successive feeding activity of fleas on pets may elicit a hypersensitivity skin disorder known as flea allergy dermatitis (FAD). Treatment of pets with ADVANTAGE rapidly kills fleas and reduces the incidence of this condition.

ADVANTAGE is safe for use on pregnant and lactating animals. It is not necessary to treat unweaned puppies and kittens as treatment of the mother protects the litter while in contact. Treat the mother until weaning, then treat individual puppies and kittens.

ADVANTAGE may be used at the same time as treatment for worms with MILBEMAX and with daily or monthly preventive treatment for heartworm. It is recommended that all dogs and cats in the same environment should be protected by ADVANTAGE.

ADVANTAGE may be used to prevent infestation in flea-free animals taken temporarily to known flea infested environments. Apply a single dose before moving to the infested environment. ADVANTAGE may be used as the only product for flea control as it breaks the life cycle and kills fleas emerging from the environment to reinfest the cat/dog. More rapid resolution of heavy environmental infestations may be obtained by additional environmental control measures using a suitable registered product. If re-treatment becomes necessary earlier than 4 weeks do not re-treat more than once weekly.

Re-treatment of rabbits and ferrets may be necessary when flea infestation is heavy. **Warning:** Take care when treating ferrets to administer the correct dose. Safety data on overdosing is not available.

ADVANTAGE has no strong chemical smell. The liquid vehicle in ADVANTAGE may discolour or damage certain surfaces and fabrics, e.g., polished floorboards, leather. Exclude the animal from contact with such surfaces until the product dries on the animals' coat.

NOT TO BE USED FOR ANY PURPOSE, OR IN ANY MANNER, CONTRARY TO THIS LABEL UNLESS AUTHORISED UNDER APPROPRIATE LEGISLATION.

SAFETY DIRECTIONS

Harmful if inhaled or swallowed. Will irritate the eyes. Avoid contact with eyes. Do not inhale vapour. If product in eyes, wash it out immediately with water. Wash hands after use.

FIRST AID

If poisoning occurs, contact a doctor or Poisons Information Centre. Phone Australia 131126.

DISPOSAL

Dispose of container by wrapping with paper and putting in garbage.

STORAGE

Store below 30°C (room temperature)

PRESENTATION

ADVANTAGE for	Pack Colour	Contents	APVMA Approval No.
Kittens & Small Cats up to 4 kg	dark orange	0.4 mL	50395/tba
Cats over 4 kg	violet	0.8 mL	50396/tba
Puppies & Small Dogs up to 4 kg	dark green	0.4 mL	50397/tba
Dog 4-10 kg	turquoise	1.0 mL	50398/tba
Dogs 10-25 kg	maroon	2.5 mL	50399/tba
Dogs over 25 kg	blue	4.0 mL	50400/tba