



Micotil® 300

(tilmicosin injection)

Safety Course

Right for cattle. Right by you.

Elanco[™]

PM-US-23-0846

Micotil®300

(tilmicosin injection)

Safety Course

Course Format and Learning Objectives

Welcome to the Micotil® Safety Course. Micotil® is an effective and game-changing tool to have in your tool kit against BRD—however, like any injectable, safety is the number one priority. Micotil should only be handled after the completion of the Micotil Safety Course to ensure the lowest risk possible of self-injection.

The Micotil® Safety Course is a four-module educational course:

- Module 1: Micotil® Overview and User Expectations
 - Micotil® Label Indications
 - Micotil® Boxed Warning
 - Micotil® User Expectations
- Module 2: Important Safety Information
 - Micotil® SAFE Principles
 - Micotil® Accidental Human Exposure
- Module 3: Safe Handling and Administration
 - Administration Recommendations
 - Usage Guidelines
 - Micotil® Shroud and Sekurus™ Safety Injector
 - Administration Technique
 - Micotil® How to Shroud Video
- Module 4: Micotil® Storage Recommendations, Review of Micotil® Label Indications and Micotil® Boxed Warning
 - Micotil® Storage Recommendations
 - Micotil® Label Indications
 - Micotil® Boxed Warning

By the end of this four-module educational course, you will be prepared for the responsible use of Micotil®. Once you take the course and complete your certification form submission, your name will be added to our Safe to Sell list and you will be given a certificate of completion which will allow you purchase and administer Micotil®.



PM-US-23-0846

Micotil®
(tilmicosin injection)

Safety Course

Module 1: Micotil® Overview and User Expectations

All products have the potential to be misused or used in an unsafe manner. It is important to understand the product label and the user expectations to ensure proper safety and administration for users and animals. This module will explain the:

1. Micotil® Label Indications
2. Micotil® Boxed Warning
3. Micotil® User Expectations

Micotil® 300 (tilmicosin injection) Safety Course

Module 1: Micotil® Overview and User Expectations

Before using this product, it is important to read the entire product insert, including the boxed human warning.

CAUTION: Federal law restricts this drug to use by or on the order of a licensed veterinarian.

HUMAN WARNINGS: Not for human use. Injection of this drug in humans has been associated with fatalities. Keep out of reach of children. Administer only with a tube-fed safety syringe. Do not use in automatically powered syringes, single-use syringes or other delivery devices. Exercise extreme caution to avoid accidental self-injection. In case of human injection, consult a physician immediately and apply ice or cold pack to injection site while avoiding direct contact with the skin. Emergency medical telephone numbers are 1-800-722-0987 or 1-800-428-4441. Avoid contact with skin, eyes or mucous membranes.

Note To The Physician: The cardiovascular system is the target of toxicity and should be monitored closely. Cardiovascular toxicity may be due to calcium channel blockade. In dogs, administration of intravenous calcium offset Micotil-induced tachycardia and negative inotropy (decreased contractility). Dobutamine partially offset the negative inotropic effects induced by Micotil in dogs. β -adrenergic antagonists, such as propranolol, exacerbated the negative inotropy of Micotil in dogs. Epinephrine potentiated lethality of Micotil in pigs. This antibiotic persists in tissues for several days.

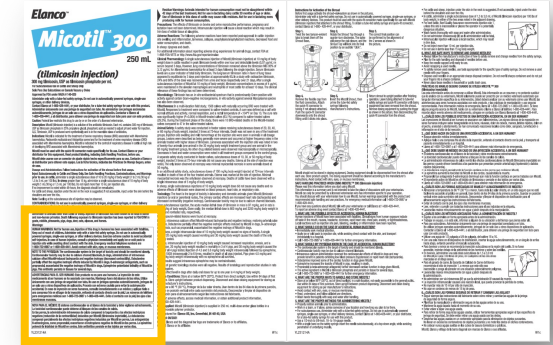

Right for cattle. Right by you.

Elanco

TM

PM-US-23-0846

Micotil® (tilmicosin injection) Safety Course

Module 1: Micotil® Overview and User Expectations

Expectations of ALL Micotil® Users

- Become certified to purchase and administer Micotil®
- Take time to read the full product label and packaging
- Display chute-side poster in all treatment facilities
- Communicate regularly with staff to reinforce good safety practices when working with animals
- Review Micotil® Safe Handling & Use annually with all staff
- Train all new staff prior to allowing the use of any injectable product, including Micotil®
- Follow Proper Drug Use Principles
 - Read, understand and follow all label use directions; in particular, observe all caution statements and human warnings
 - Consult with your veterinarian to determine which product is most appropriate for your situation
- Store Micotil® in a secure location

[illegible]

Chute Side Poster

Right for cattle. Right by you.

Elanco

TM

PM-US-23-0846

Micotil® (tilmicosin injection) Safety Course

Module 1: Micotil® Overview and User Expectations

Expectations of ALL Micotil® Users

Take time to read the Client Dispensing Information

- Easy to read and understand format
- Contains:
 - Proper Micotil® Administration Procedures
 - Protective Shroud and Safety Syringe
 - Proper Handling Procedures
 - Important Safety Information
 - What to do in case of accidental self-injection
 - Who to call if you have questions



MICOTIL® (TILMICOSIN INJECTION)

CLIENT DISPENSING INFORMATION

Micotil is indicated for treatment of BRD associated with *Mannheimia haemolytica*, *Pasteurella multocida* and *Histophilus somni*, and for the control of respiratory disease in cattle at high risk of developing BRD associated with *M. haemolytica*.

PROPER MICOTIL ADMINISTRATION PROCEDURES

- Properly restrain animals prior to administering Micotil.
- With a single hand on the syringe, insert the needle subcutaneously, at a top-down angle, while avoiding penetration of underlying muscle.
- Administer a single subcutaneous dose of 1.5 to 3 mL of Micotil per 100 lbs. of body weight in the area.
- Administer a single subcutaneous dose of 1.5 mL to 3 mL of Micotil per 100 lbs. of body weight.
- Ensure proper disposal of needles, syringes and used bottles.
- If syringe is broken or damaged in any way, discontinue use immediately.
- Exercise caution and care when removing needle from syringe.

Micotil is supplied with a protective, ergonomic case called a shroud and a safety syringe. For your safety, the shroud cannot be removed. Micotil should only be administered with the provided tube-fed safety syringe. This safety syringe leverages self-venting and needle-guard features. The syringe reduces the chance of accidental self-injection and withstands the most challenging environments. Reference the product administration guide for detailed instructions when working with the shroud and safety syringe.

PROTECTIVE SHROUD AND SAFETY SYRINGE

PROPER HANDLING PROCEDURES

- Store Micotil in a lockable cabinet, container or a secure storage room to prevent the risk of misuse is recommended.
- Recommended storage includes a lockable cabinet or container or a secure storage room, depending on the amount of product in inventory.
- Keep full or empty Micotil bottles, used syringes and needles out of the reach of children and the general public.
- Read, understand and follow all label use directions.
- Micotil must be used with the quick-fit connector made specifically for its use. Contact Elanco or your distributor for this equipment.
- For subcutaneous use. Do not use in automatically powered syringes.
- Use a 1/2" to 5/8" 18- to 16-gauge needle.
- Keep a protective cover on needles until ready to use.
- Never carry loaded syringes in pocket or clothing.
- Wash hands thoroughly with soap and water after handling.
- Access to Micotil should be limited to personnel trained in safe handling and use procedures.

WHAT TO DO IN CASE OF SELF-INJECTION

Seek immediate medical attention and:



REACH
for and apply ice pack



REFERENCE
product label and provide to emergency medical personnel



REMEMBER
to call SafetyCall at 800-722-0687 or Elanco at 800-428-4441

Operation name _____ Signed Producer _____
Operation address _____ Date _____
Operation city, state and ZIP _____
Number of animals _____ Location _____ Signed Doctor _____
Comments _____ Date _____

white copy: producer | yellow copy: veterinarian



Right for cattle. Right by you. 

Client Dispensing Information

Right for cattle. Right by you.

Elanco

TM

PM-US-23-0846

Micotil® (tilmicosin injection) Safety Course

Module 1: Micotil® Overview and User Expectations

Expectations of Veterinarians

- Veterinarians should be trained and recertified by Elanco representatives or complete the online training modules.
- Veterinarians should discuss Micotil® safe handling and use with their clients and work with clients to define a proper, secure storage location prior to dispensing.
- Dispense Micotil® when a valid Veterinarian-Client-Patient Relationship (VCPR) is in place.
- Veterinarians should develop their own procedure to document (i.e., Safe to Sell list) which clients have been trained.

Expectations of Suppliers

- Suppliers should be trained and recertified by Elanco representatives or complete the online training modules
- Suppliers should discuss Micotil® safe handling and use with their clients before dispensing Micotil®.
- Suppliers should develop their own procedure to document (i.e., Safe to Sell list) which clients have been trained.
- Upon receipt of Micotil® orders, suppliers should check their Safe to Sell list to ensure accounts are active before dispensing

[illegible]

Chute Side Poster

Right for cattle. Right by you.

Elanco

TM

PM-US-23-0846

Micotil[®] (tilmicosin injection) Safety Course

Module 1: Micotil[®] Overview and User Expectations

As you can see, a proper understanding of the label indications and user expectations reduces the potential for products to be misused or used in an unsafe manner.

Our next module will go on to cover an overview of Important Safety Information for Micotil[®].

Right for cattle. Right by you.



PM-US-23-0846

Micotil®
(tilmicosin injection)

Safety Course

Module 2: Important Safety Information Overview

Safety is imperative when handling any injectable product, including Micotil®. This module will explain the:

1. Micotil® SAFE Principles
2. Micotil® Accidental Human Exposure

Micotil[®] (tilmicosin injection) Safety Course

Module 2: Important Safety Information Overview

Safe Use Principles

Principle 1: **S**afety for you (caregiver)

Principle 2: **A**nimal Safety

Principle 3: **F**ood Chain Safety

Principle 4: **E**nvironmental Safety



Right for cattle. Right by you.

Elanco™

PM-US-23-0846

Micotil® (tilmicosin injection) Safety Course

Module 2: Important Safety Information Overview

Safe Use Principles: Principle 1 Safety for you (caregiver)

Exercise Caution to Avoid Accidental Self-injection

- Keep children and bystanders out of work area
- Properly restrain all animals
- Be aware of uneven or changing walking surfaces
- NEVER work alone – always work in a team
- Clearly establish a team leader and roles
- Evaluate the experience of those around you
- Identify an exit route



Right for cattle. Right by you.

Elanco

TM

PM-US-23-0846

Micotil® (tilmicosin injection) Safety Course

Module 2: Important Safety Information Overview

Safe Use Principles: Principle 1 Safety for you (caregiver)

Syringe and Needle Precautions

- Keep needles properly covered until use
- Exercise caution and care when removing needle from syringe to not pierce skin with needle
- **ALWAYS** use safety syringe with quick connect draw off tubing
 - Elanco **ONLY** recommends use of the Sekurus™ Safety Injector, which features a two-stage activation process to reduce risk of accidental injection
 - Do not use in automatically powered syringes (hydraulic, CO2 or needleless) where delivery of injection cannot be controlled
 - Do not use non-safety self refilling syringes or disposable syringes
 - Handle loaded syringes with care
 - Carry syringe in proper manner to ensure safe handling
 - Only carry loaded syringes in a tote or container; NEVER carry loaded syringes in your clothing
 - If syringe is broken or damaged in any way, discontinue use immediately and replace



Right for cattle. Right by you.

Elanco

TM

PM-US-23-0846

Micotil[®] (tilmicosin injection) Safety Course

Module 2: Important Safety Information Overview

Safe Use Principles: Principle 2 Animal Safety

- Use adequate facilities
 - Squeeze chute
 - Head gate
- Minimize handling stress in accordance with animal behavior
- Adjust your activity to the temperament of each animal
- If an animal cannot be properly restrained or there is concern about operator skill, consider using alternative treatments



Right for cattle. Right by you.

Elanco™

PM-US-23-0846

Micotil® (tilmicosin injection) Safety Course

Module 2: Important Safety Information Overview

Safe Use Principles: Principle 3 Food Chain Safety

- Use only FDA-approved products
- Strictly observe label directions
 - Dose, route, cautions, warnings, withdrawal times, etc.
- Record all products administered
 - ✓ Animal ID
 - ✓ Date treated
 - ✓ Product used
 - ✓ Dosage
 - ✓ Route and location of administration
 - ✓ First marketing date to meet withdrawal requirements (Pre-slaughter withdrawal time for Micotil is 42 days)



Right for cattle. Right by you.

Elanco

TM

PM-US-23-0846

Micotil® (tilmicosin injection) Safety Course

Module 2: Important Safety Information Overview

Safe Use Principles: Principle 4 Environmental Safety

- Post-emergency procedures and contacts
Call:
 - SafetyCall International at 1-800-722-0987 or
 - Elanco Animal Health at 1-800-428-4441
- Remove potential hazards in work area
- Repair or remove broken equipment
- Properly dispose of used needles and bottles
- Recycle all injectable syringes and bottle packaging



MICOTIL® (TILMICOSIN INJECTION)

DOSE AND ADMINISTRATION



MICOTIL DOSAGE CHART

Animal weight (lbs.)	MICOTIL DOSAGE		
	1.5 mL/100 lbs. body weight	2.25 mL/100 lbs. body weight	3 mL/100 lbs. body weight
200	3.00	4.50	6.00
300	4.50	6.75	9.00
400	6.00	9.00	12.00
500	7.50	11.25	15.00
600	9.00	13.50	18.00
700	10.50	15.75	21.00
800	12.00	18.00	24.00
900	13.50	20.25	27.00
1,000	15.00	22.50	30.00

PROPER MICOTIL HANDLING PROCEDURES

- Store Micotil in a secure location to prevent the risk of misuse. Recommended storage includes a lockable cabinet or container or a secure storage room, depending on the amount of product in inventory.
- Keep full or empty Micotil bottles, used syringes and needles out of the reach of children and the general public.
- Read, understand and follow all label use directions.
- For subcutaneous use. Do not use in automatically powered syringes.
- Use a 1/2" to 5/8" 16- or 18-gauge needle.
- Keep a protective cover on needles until ready to use.
- Never carry loaded syringes in pockets or by hand.
- Wash hands thoroughly with soap and water after handling.
- Access to Micotil should be limited to personnel trained in safe handling and use procedures.

PROPER MICOTIL ADMINISTRATION PROCEDURES

- Properly restrain animal prior to administering Micotil.
- With a single hand on the syringe, insert the needle subcutaneously at a top-down angle while avoiding penetration of underlying muscle.
- Administer a single subcutaneous dose of 1.5 to 3 mL of Micotil per 100 lbs. of body weight in the area noted in the illustration.
- Ensure proper disposal of needles, syringes and used bottles.
- If syringe is broken or damaged in any way, discontinue use immediately.
- Exercise caution and care when removing needles from syringe.



WHAT TO DO IN CASE OF SELF-INJECTION

Seek immediate medical attention and:



REACH
for any safety key pack



REFERENCE
product label and provide to emergency medical personnel



REMEMBER
to call SafetyCall at 800-722-0987 or Elanco at 800-428-4441

IMPORTANT MICOTIL SAFETY INFORMATION

Before using this product, it is important to read the entire product insert, including the boxed human warning. Caution: Federal law restricts this drug to use by or on the order of a licensed veterinarian.

Not for human use. Injection of this drug to humans has been associated with fatalities. Keep out of reach of children. Administer only with a calibrated safety syringe. Do not use in automatically powered syringes, single-use syringes, or other delivery devices. Exercise extreme caution to avoid accidental self-injection. In case of human injection, control a physician, immediately and apply ice or cold pack to injection site after removing blood contact with the skin. Avoid contact with eyes.

Always use proper drug handling procedures to avoid accidental self-injection. Consult your veterinarian on the safe handling and use of all injectable products prior to administration. For use in cattle or sheep only, right subcutaneously between the ribs and the spine, close to the back, in the neck and/or in the rump area. Do not use in female dairy cattle 20 months of age or older due to the risk of milk reduction or mastitis. Do not use in female dairy cattle or sheep only, cause milk reduction. The following adverse reactions have been reported in cattle: reaction to the product and ingredients, lameness, colic, diarrhea, anorexia, depression, decreased food intake, decreased food and water consumption, and death. Micotil has a pre-dilution withdrawal time of 42 days.



Micotil® 300

(tilmicosin injection)

250 mL

25 mg Tilmicosin (10% w/v) 250 mL (2.5 mL/100 lbs. body weight)

Caution: Federal law restricts this drug to use by or on the order of a licensed veterinarian.

Keep out of reach of children. Administer only with a calibrated safety syringe. Do not use in automatically powered syringes, single-use syringes, or other delivery devices. Exercise extreme caution to avoid accidental self-injection. In case of human injection, control a physician, immediately and apply ice or cold pack to injection site after removing blood contact with the skin. Avoid contact with eyes.

Always use proper drug handling procedures to avoid accidental self-injection. Consult your veterinarian on the safe handling and use of all injectable products prior to administration. For use in cattle or sheep only, right subcutaneously between the ribs and the spine, close to the back, in the neck and/or in the rump area. Do not use in female dairy cattle 20 months of age or older due to the risk of milk reduction or mastitis. Do not use in female dairy cattle or sheep only, cause milk reduction. The following adverse reactions have been reported in cattle: reaction to the product and ingredients, lameness, colic, diarrhea, anorexia, depression, decreased food intake, decreased food and water consumption, and death. Micotil has a pre-dilution withdrawal time of 42 days.

Right for cattle. Right by you. 

Chute Side Poster

Right for cattle. Right by you.

Elanco

TM

PM-US-23-0846

Micotil® (tilmicosin injection) Safety Course

Module 2: Important Safety Information Overview

Safe Use Principles: Principle 4 Environmental Safety

Possible Effects of Accidental Human Injection

- Human injections of Micotil have been associated with fatalities
- Clinical signs of human exposure include off-taste in the mouth, nausea, headache, dizziness, rapid heart rate, chest pain, anxiety or lightheadedness
- Local reactions such as injection site pain, bleeding, swelling or inflammation have been reported

Human-Exposure Actions

- If accidental exposure occurs seek immediate medical attention:
 - REACH for and apply ice pack
 - REFERENCE product label “Note To The Physician” and/or product insert and provide to doctor
- REMEMBER to contact SafetyCall at 1-800-722-0987 or Elanco Animal Health at 1-800-428-4441 (select product support)

WHAT TO DO IN CASE OF SELF-INJECTION

Seek immediate medical attention and:



REACH
for and apply ice pack



REFERENCE
product label and
provide to emergency
medical personnel



REMEMBER
to call SafetyCall
at **800-722-0987** or
Elanco at **800-428-4441**

Right for cattle. Right by you.

ElancoTM

PM-US-23-0846

Micotil[®] (tilmicosin injection) Safety Course

Module 2: Important Safety Information Overview

As you can see, safety precautions must be taken across all fronts. This ensures that all parties are kept healthy and safe.

Our next module will go on to cover the Safe Handling and Administration of Micotil[®].

Right for cattle. Right by you.



PM-US-23-0846

Micotil®
(tilmicosin injection)

Safety Course

Module 3: Safe Handling and Administration

This module will cover the handling and administering of Micotil® to ensure the best safety protocols are taken. When administration recommendations are taken into account, this allows for a reduced risk of injury to both the animal and the human.

This module will explain:

1. Administration Recommendations
2. Usage Guidelines
3. Micotil Shroud and Sekurus Syringe
4. Administration Technique
5. Micotil® How to Shroud Video

Micotil® (tilmicosin injection) Safety Course

Module 3: Safe Handling and Administration

Administration Recommendations

- Always keep needles properly covered until ready to use
- Carry syringe in proper manner to ensure safe handling
- Handle loaded syringes with care
- Never carry loaded syringes in coat or pockets
- If syringe is broken or damaged in any way, discontinue use immediately and replace
- Exercise caution and care when removing needle from syringe so as not to pierce skin with needle
- Elanco recommends that Micotil® be administered only by those individuals who have received safe handling and use training from their veterinarian or an Elanco representative
- Producers should consider designating one trained and responsible individual on their animal health team to administer Micotil®
- It is recommended that Micotil® only be used in situations where animals can be properly restrained
 - Producers should consult their veterinarian for specific restraint recommendations
- Generally, proper animal restraint would include restraint via a squeeze chute, head gate, headlock or similar device



Right for cattle. Right by you.

Elanco

TM

PM-US-23-0846

Micotil[®] (tilmicosin injection) Safety Course

Module 3: Safe Handling and Administration

Usage Guidelines

- Administer only with a tube-fed safety syringes. Do not use in automatically powered syringes, single-use syringes, or other delivery devices not specified in the labeling.
- Inject subcutaneously in cattle and sheep only. Do not administer intravenously; intravenous injection will be fatal
 - In cattle, administer a single subcutaneous dose of 10 to 20 mg/kg of body weight (1.5 to 3 mL/100 lbs). Do not use in female dairy cattle 20 months of age or older. Use of tilmicosin in this class of cattle may cause milk residues. Do not use in lactating ewes if the milk is intended for human consumption.
 - In sheep greater than 15 kg (30 lb), administer a single subcutaneous dose of 10 mg/kg of body weight (1.5 mL/100 lbs). Do not use in lambs less than 15kg (30lb) body weight.
 - Do not inject more than 10 mL per injection site
- Animals intended for human consumption must not be slaughtered within 42 days of the last treatment
- If no improvement is noted within 48 hours, the diagnosis should be re-evaluated.
- Injection of tilmicosin has been shown to be fatal in swine and non-human primates. Death following exposure to tilmicosin injection has been reported to FDA/CVM in goats, rabbits, pheasants, pigs, dogs, deer, cats, alpacas, and horses.
- Effects of tilmicosin on bovine and ovine reproduction, pregnancy and lactation have not been determined

Right for cattle. Right by you.



PM-US-23-0846

Micotil® (tilmicosin injection) Safety Course

Module 3: Safe Handling and Administration

Micotil® Bottle Shroud and Sekurus™ Safety Injector

- Micotil® is supplied with a protective, ergonomic case called a shroud. For your safety, the shroud cannot be removed.
- The shroud must be activated and connected to the appropriate quick connect draw-off tubing prior to use.
- The shroud offers added protection from breakage during the handling of bottles.
- Micotil® should only be administered with the Sekurus™ Safety Injector.
 - To obtain a Sekurus™ Safety Injector for the administration of Micotil®, please contact your Elanco Sales Representative or call 800-362-2014.



Right for cattle. Right by you.

Elanco

TM

PM-US-23-0846

Micotil® (tilmicosin injection) Safety Course

Module 3: Safe Handling and Administration

Micotil® Bottle Shroud

- All product information contained in accordion style label on Micotil® packaging
- Easy to read & understand format
- Discusses safety to the worker
- Contains:
 - Important safety information
 - Shroud activation instructions
 - What to do in case of accidental self-injection
 - Who to call if you have questions



Right for cattle. Right by you.

Elanco

TM

PM-US-23-0846

Micotil® (tilmicosin injection) Safety Course

Module 3: Safe Handling and Administration

Micotil® Bottle Shroud- Use Instructions

1. Gather materials to administer Micotil®. Materials needed include the 250 ml product bottle encased in the protective shroud, a tube-fed safety syringe and an appropriately sized needle for subcutaneous injection. Micotil® should only be administered with the quick-fit connector made specifically for its use along with the tube-fed safety syringe.
2. Locate the two tamper-evident tabs at the base of the shroud. Twist and break them off.
3. Rotate the shroud top a quarter-turn clockwise. The top will lower and the spike will pierce the vial closure. An audible click should be heard as the shroud top locks into its final position.
4. Remove the flexible cap and push the quick-fit connector downwards onto the shroud fitting until it clicks into place. At this point, the tube should already be connected to your safety syringe.
5. Invert the shroud to prime the safety syringe.

Instructions for Activation of the Shroud

Before first usage activate the shroud-vial-system as shown in the pictures. Administer only with a tube-fed safety syringe. Do not use in automatically powered syringes, single-use syringes, or other delivery devices. This product must be used with the quick-fit connector made specifically for use with Micotil (tilmicosin injection) that attaches to the shroud fitting. To obtain a tube-fed safety syringe and quick-fit connector, contact Elanco at 1-800- 428-4441, or your distributor.

Step 1. Twist the two tamper-evident tabs to break them off the Shroud Base.

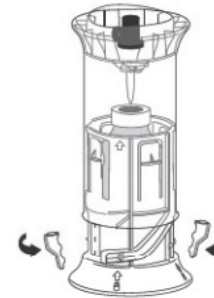

Step 2. Rotate the Shroud Top through a quarter-turn clockwise. The spike will pierce the vial closure, and the Shroud Top will lock into its final position by an audible "click".



Step 3. The correct final position can be confirmed by the alignment of the 2 arrows as shown in the picture.

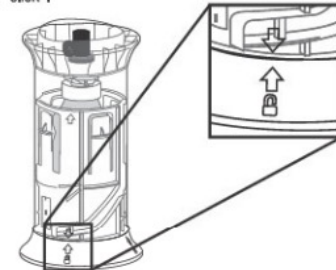

Step 4. Remove the flexible cap from the fluid connection. Attach the quick-fit connector to tubing if not already attached. Push the quick-fit connector downwards onto the shroud fitting until it clicks into place.

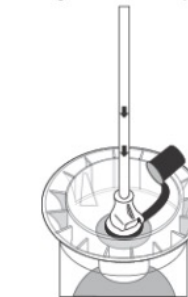

Step 5. Invert the Micotil Shroud, then prime the tube-fed safety syringe following manufacturer's instructions.

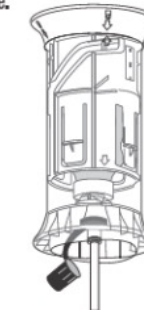

Return shroud to upright position after finishing operation. Leave tubing attached to tube-fed safety syringe and quick-fit connector until dosing equipment has been removed from the shroud. Remove dosing equipment by pushing the trigger as shown in the picture, then disconnecting the quick-fit connector from the shroud.

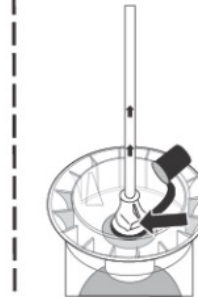

Right for cattle. Right by you.

Elanco

TM

PM-US-23-0846

Micotil® (tilmicosin injection) Safety Course

Module 3: Safe Handling and Administration

Sekurus™ Safety Injector

- Elanco recommends use of the Sekurus™ Safety Injector, which features a 2-stage activation process to reduce risk of accidental injection
- Patented self-tenting technology
 - Makes sure operator's hand is not close to injection site
- Two-stage activation
 - To activate, pull the trigger & then push the syringe cone against the animal
 - Both must be performed in order to expose the needle & insert it into the animal
 - Depress the syringe handle to inject Micotil® into the animal



Right for cattle. Right by you.

Elanco

TM

PM-US-23-0846

Micotil® (tilmicosin injection) Safety Course

Module 3: Safe Handling and Administration

Sekurus™ Safety Injector- Use Instructions

- Prime the safety syringe
- Set the dose adjuster to the maximum setting.
- Grasp the safety syringe and depress the trigger with the forefinger
- Using your spare hand, pull the needle guard back and hold in this retracted position for the remainder of the priming procedure.
- Squeeze and release the safety syringe handles repeatedly to draw product through the tube. Once the product enters the barrel, carefully squeeze handles to expel remaining air. Tilt the syringe upward to help get as much air out of the barrel as possible. Use caution to avoid spillage of product.
- Allow the needle guard to return forward and release trigger.
- Set the dose adjuster to the required setting.



Right for cattle. Right by you.

Elanco

TM

PM-US-23-0846

Micotil® (tilmicosin injection) Safety Course

Module 3: Safe Handling and Administration

Sekurus™ Safety Injector- Use Instructions cont.

- To attach the needle, remove the needle guard by grasping the safety syringe and press needle guard release tab with your thumb. Remove the guard with your other hand.
 - Keep your thumb and fingers on the metal slide so they are well clear of the trigger.
 - Remove the cap from the needle cover (do not remove the cover from the needle until it is attached to the syringe.)
 - Use the needle cover to properly fit the appropriately sized needle (proper needle length should be ½" to 5/8") onto the tip and rotate clockwise to engage threads. Avoid over tightening the needle.
 - To remove the needle, place the needle cover over the needle and twist in the opposite direction (counterclockwise)
 - If needle cannot be removed using needle cover, use needle-nosed pliers to remove. Never remove by hand.
 - Replace the needle guard by aligning it with the metal slide and push so that the release tab of the needle guard clips into place.



Right for cattle. Right by you.

Elanco

TM

PM-US-23-0846

Micotil® (tilmicosin injection) Safety Course

Module 3: Safe Handling and Administration

Sekurus™ Safety Injector- Use Instructions cont.

- Injecting with the gun
 - Place the cone of the syringe onto the neck area at a downward angle
 - Simultaneously push cone of the syringe into neck while depressing the syringe trigger to expose the needle & penetrate the skin
 - Once the needle has penetrated the skin, shift the hand with syringe toward the animal, pulling the skin away from the deeper muscle tissue
 - Depress the handle to complete the injection
- **Remember**
 - DO NOT use the opposite hand to tent the skin
 - Use only one hand (the other hand should be kept away from the injection area)
 - Ensure proper disposal of needles, syringes and used bottles
 - Discuss any concerns with your veterinarian



Right for cattle. Right by you.

Elanco

TM

PM-US-23-0846

Micotil[®] (tilmicosin injection) Safety Course

Module 3: Safe Handling and Administration

Administration Technique

- Select a 1/2" to 5/8", 18- to 16- gauge needle
- With a single hand on the syringe, insert the needle subcutaneously, at a top-down angle, while avoiding penetration of underlying muscle
- Injection under the skin in the neck is suggested. If not accessible, inject under the skin behind the shoulders and over the ribs
- Administer a single subcutaneous dose of 10 to 20 mg/kg of body weight (1 to 2 mL/30 kg or 1.5 to 3 mL per 100 lbs)

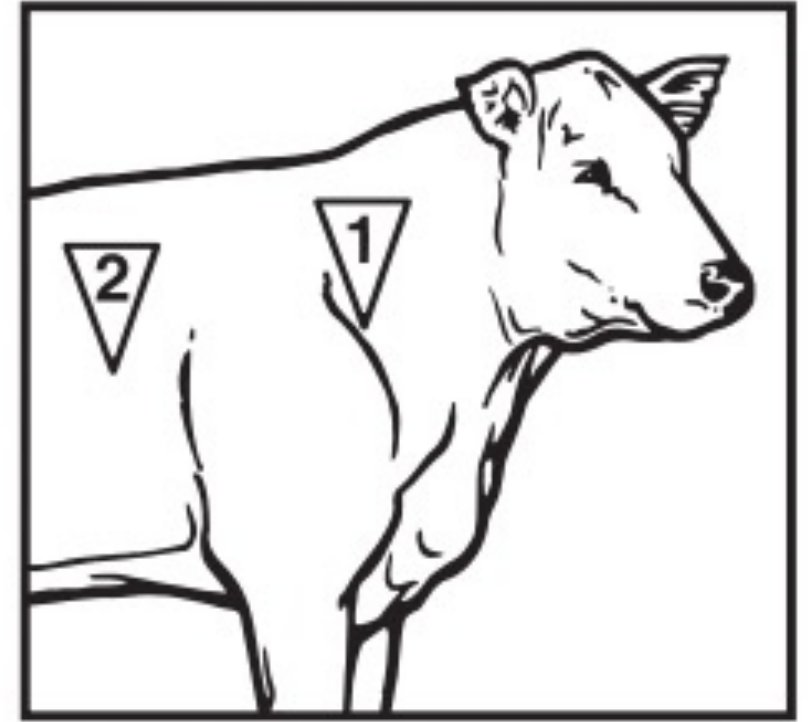

Right for cattle. Right by you.

Elanco

TM

PM-US-23-0846

Micotil[®] (tilmicosin injection) Safety Course

Module 3: Safe Handling and Administration

Micotil[®] How to Shroud Video

For a video demonstration of how to use the Micotil[®] Bottle Shroud and Sekurus Device please visit the link below or click play on the video embedded in this slide.

<https://www.youtube.com/watch?v=jbKsKgCsl44>



Right for cattle. Right by you.

ElancoTM

PM-US-23-0846

Micotil[®] (tilmicosin injection) Safety Course

Module 3: Safe Handling & Administration

By adhering to these usage and administration guidelines, you can be confident in your safe use of Micotil[®] .

Our next module will go on to cover the Micotil[®] Storage Recommendations and a final review of the Micotil[®] Label Indications and Micotil[®] Boxed Warning.

Right for cattle. Right by you.



PM-US-23-0846

Micotil®
(tilmicosin injection)

Safety Course

Module 4: Micotil® Storage Recommendations, Review of Micotil® Label Indications and Micotil® Boxed Warning

Once you finish using Micotil®, storing it in a safe place is just as important. By doing this, you ensure that only those allowed to administer Micotil® can access it, and that it will stay out of reach of the general public. This module will cover the storage of Micotil® to prevent misuse and perform a final review of the label indications and boxed warning.

1. Micotil® Storage Recommendations
2. Micotil® Label Indications
3. Micotil® Boxed Warning

Micotil® (tilmicosin injection) Safety Course

Module 4: Micotil® Storage Recommendations, Review of Micotil® Label Indications and Micotil® Boxed Warning

Storage Recommendations

- Storage of Micotil® in a secure location to prevent misuse is recommended. The risk of misuse by humans should be considered when storing, administering and disposing of Micotil®.
- Recommended storage method is in a locked cabinet, storage room or a similar secure container, depending on inventory
- Keep full or empty Micotil® bottles, used syringes and needles out of the reach of children and the general public.
- Store at or below 86° (30°C). Protect from direct sunlight. Use within 84 days of first puncture. Store upright between product dispensing. Disconnect and clean dosing equipment for storing as per manufacturer's instructions



Right for cattle. Right by you.

Elanco

TM

PM-US-23-0846

Micotil® 300 (tilmicosin injection) Safety Course

Module 4: Micotil® Storage Recommendations, Review of Micotil® Label Indications and Micotil® Boxed Warning

Before using this product, it is important to read the entire product insert, including the boxed human warning.

CAUTION: Federal law restricts this drug to use by or on the order of a licensed veterinarian.

HUMAN WARNINGS: Not for human use. Injection of this drug in humans has been associated with fatalities. Keep out of reach of children. Administer only with a tube-fed safety syringe. Do not use in automatically powered syringes, single-use syringes or other delivery devices. Exercise extreme caution to avoid accidental self-injection. In case of human injection, consult a physician immediately and apply ice or cold pack to injection site while avoiding direct contact with the skin. Emergency medical telephone numbers are 1-800-722-0987 or 1-800-428-4441. Avoid contact with skin, eyes or mucous membranes.

Note To The Physician: The cardiovascular system is the target of toxicity and should be monitored closely. Cardiovascular toxicity may be due to calcium channel blockade. In dogs, administration of intravenous calcium offset Micotil-induced tachycardia and negative inotropy (decreased contractility). Dobutamine partially offset the negative inotropic effects induced by Micotil in dogs. β -adrenergic antagonists, such as propranolol, exacerbated the negative inotropy of Micotil in dogs. Epinephrine potentiated lethality of Micotil in pigs. This antibiotic persists in tissues for several days.

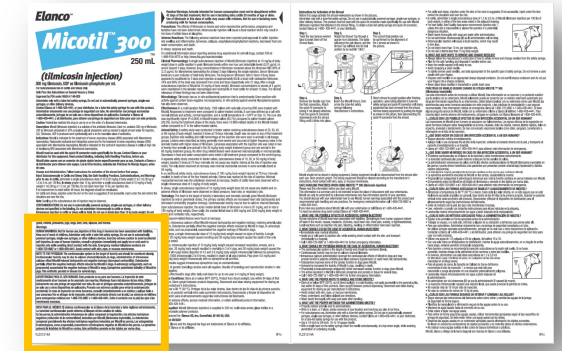

Right for cattle. Right by you.

Elanco

TM

Micotil® (tilmicosin injection) Safety Course

Module 4: Micotil® Storage Recommendations, Review of Micotil® Label Indications and Micotil® Boxed Warning

As you can see, storage is just as important as every other step we have discussed today. It is also important to understand the product label to ensure proper safety and administration for users and animals.

Right for cattle. Right by you.



PM-US-23-0846

Micotil[®] (tilmicosin injection) Safety Course

Thank you for completing the Micotil[®] (tilmicosin injection) Safety Course. We hope that this educational course has provided lifelong safety information to you, and that you will follow these protocols while administering Micotil[®] and other injectables for maximum safety.

Please download the Certification Signature Page from the Micotil Safety Training site, sign, and send completed form to Micotil_Certification@elanco.com.

For questions regarding Micotil[®] or this Safety Course, please contact your Elanco Sales Representative or call 800-362-2014.

Micotil, Elanco and the diagonal bar logo are trademarks of Elanco and its affiliates.
Other company and product names are trademarks of their respective owners.
©2023 Elanco

Right for cattle. Right by you.



PM-US-23-0846



Right for cattle.



ElancoTM

Right by you.

PM-US-23-0846